

BLOCK+BLEED

Block & Bleed Manifolds for Ultrasonic Flow Meter Applications

Ultrasonic flow meters are used to measure hydrocarbon gases in applications which require wide range (turn-down ratio), very high or low flow, low restriction, high accuracy or any combination of these from low pressure to super-high pressure.

All gas transactions are made under such predetermined/agreed conditions for example Standard Cubic Feet, Normal Cubic Feet where the reference temperature and pressure are normalized and corrected to.

All volumetric flow meters when used for gas, natural gas or steam applications need to be normalized and compensated for pressure and temperature variations as they have a huge impact on the density of the gas and as a consequence on its standard volume. Therefore it is often required to install a pressure measurement so the flow computers can compensate for it.

Two ways are possible

The pressure hook-ups can be installed in 2 ways: Either using a remote installed hook-up, which requires manufacturing and installation of tube runs, fittings, additional valves or expensive pipe stands or using a Close Coupled Manifold which reduces potential leak points and provides a safe compact leak free measurement installation.

The expectation of the users is to get an accurate result of the pressure measurement. But long gauge lines will definitely cause inaccurate measurements because the lines dampen the signal read at the pressure transmitter. Liquids and condensate in long gauge lines can potentially freeze causing measurement error.

AS-Schneider Solution

AS-Schneider is providing two Close Coupled Block & Bleed Manifolds for these applications – Flanged Style and Threaded Style. Both manifolds are Multiport Types (3 outlet ports) and are Fully Roddable. The Bore Size of the isolation valve is 1/4" (6.35 mm). The Clearance of Process Connection to Transmitter is approx. 8". For more details please see on our website www.as-schneider.com the brochure 'AS-4302 | Soft Seated Needle Valves and Manifolds' or contact your AS-Schneider Sales Partner.



Features and Benefits of a Close Coupled Hook-up:

- Minimizes or Eliminates of Gauge Line Errors
- Reduces Freezing Issues
- Reduces Installation Cost – no need to manufacture and install tube runs, fittings, and expensive pipe stands
- Reduces Potential Leak Points associated with NPT Connections
- Provides a Safe Compact Leak Free Measurement Installation

Example for a Vertical Installation

Mini Valve assembled to 1/4 NPT bleed/calibrate connection, 2 outlet ports 1/2 NPT plugged.

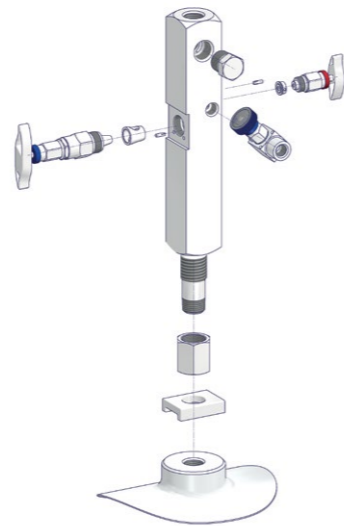

Flow Pattern – Threaded Style Flow Pattern – Flanged Style

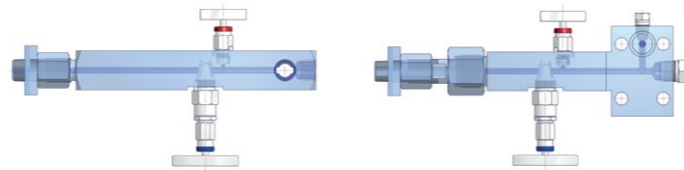

FULLY RODDABLE

AS-Schneider Close Coupled Block & Bleed Manifolds are Multiport Types and Fully Roddable.

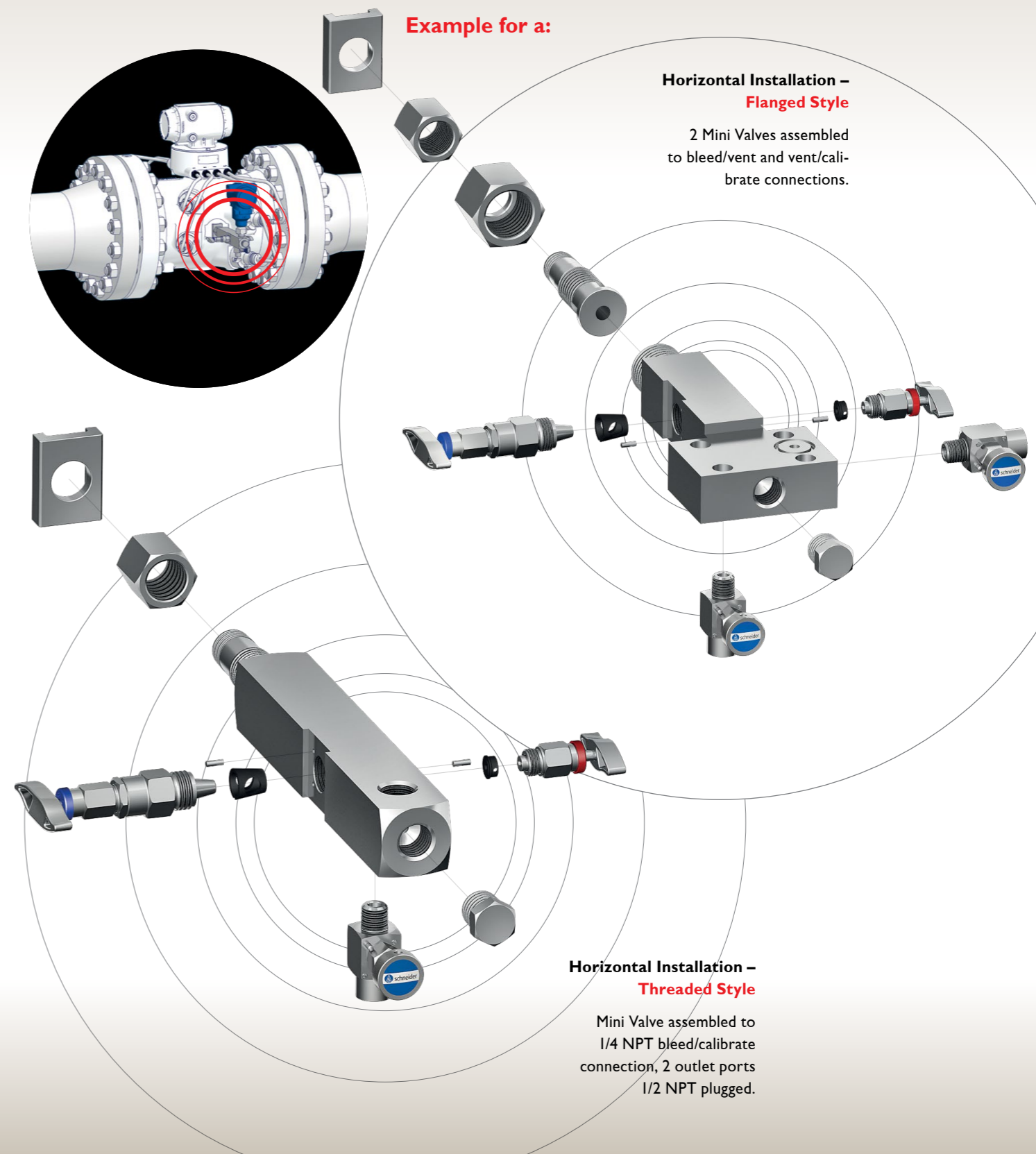

Example for a:

Horizontal Installation – Flanged Style

2 Mini Valves assembled to bleed/vent and vent/calibrate connections.

Horizontal Installation – Threaded Style

Mini Valve assembled to 1/4 NPT bleed/calibrate connection, 2 outlet ports 1/2 NPT plugged.